

# ACCESS RECYCLING UNIT

DESIGN BY EDSBYN



A practical recycling unit in a stylish design, with handles in lacquered steel. It is part of the Access series where function and choice are the focus. In response to today's needs for efficient solutions for workplaces, Edsbyn has developed a practical recycling unit. So that our workplaces will be like the meeting place we want. You can choose between colours white, light grey and dark grey. The top comes in HPL. The unit has a depth of 544 mm. The container holds about 93 liters and fits with garbage bags of 125 liters.



## CONFIGURATION

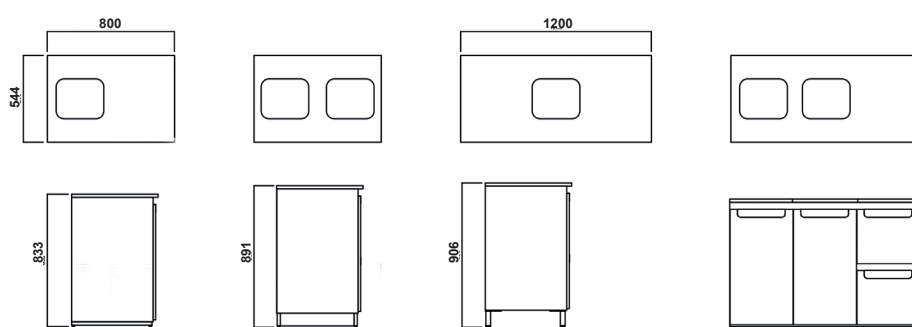

## COLOURS & MATERIALS

### WOOD

White laminate		White glazed ash		Bay leaf green S4020-G30Y	
Light grey laminate		Oak veneer		Dark grey S 7000-N	
Dark grey laminate		White S 0500-N		Feem green S 7010-G30Y	
Birch veneer		Light grey 2500-N		Petroleum S7020-B10G	
Ash veneer		Sandy Grey S 2005 -Y50R		Black S 9000-N	

Designer Edsbyn