

5



Tryck till hårt när ramen är inskjuten så att det hörs ett KLICK, därefter är ramen "låst" mot expansionerna.

Give the file frame a hard push until you hear a CLICK, after that the frame is "locked" into the expansions.

6

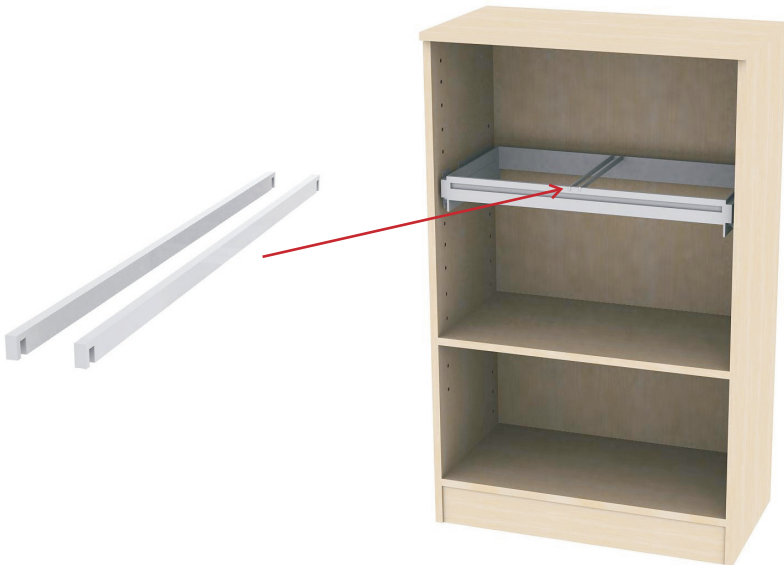

Monteringsanvisning - Assembly instruction

Hängmappsram
Suspended file frame



AB Edsbyverken, Box 300, SE-828 25 Edsbyn
Tel/Phone +46 (0)271-27500, Fax +46 (0)271-27501
www.edsbyn.com

Date: 2007-10-03

Nr: 00530044

1

Montera i expansionens första hål.
Assemble in the first hole of the expansion.

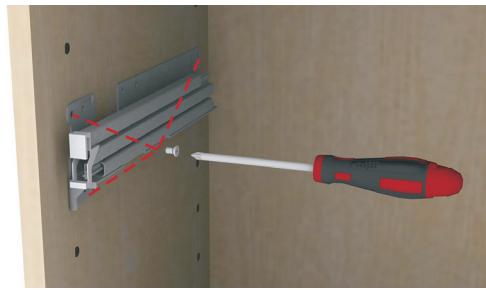

Vi rekommenderar att inte montera fler än en mappram. Om fler mappramar önskas SKALL ett antitilt-system monteras. Detta bör göras från fabrik.

We do not recommend assembly of more than one file frame. If more than one file frame are wanted an anti-tilt device HAS TO be assembled. That should be done in the factory.



2

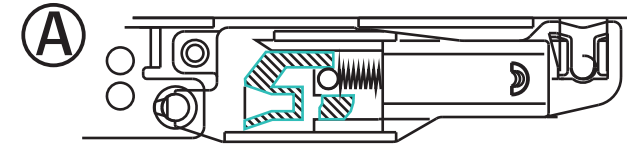

Aktivera antitilt mekanismen med att dra framåt, uppåt så att den placeras enligt bild B. Detta SKALL göras innan mappramen monteras.

Activate the anti-tilt device by pulling it forward, upward for getting it in the same position as picture B. This SHOULD be done before assembly of the file frame.

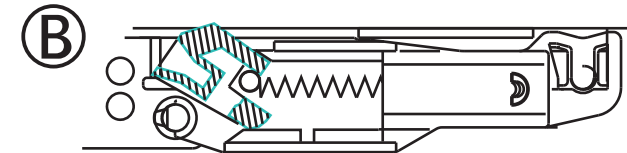

3

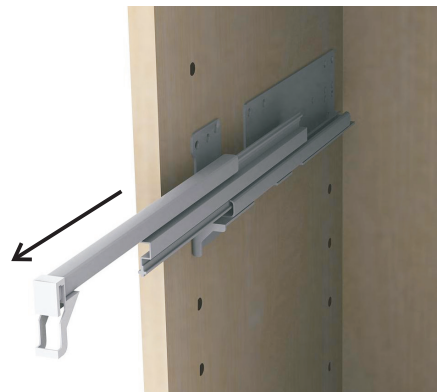

4



Skjut in mappramen på expansionerna så att bakkanten låses fast i hakarna som finns utstansade på expansionernas bakkant.

Push the file frame into the expansions, make sure that the back is fixed in the hooks on the back edge of the expansions.