

# ASSEMBLY INSTRUCTIONS

## PART FL



AB Edsbyverken, Box 300, SE-828 25 Edsbyn  
Tel/Phone +46 (0)271-27500, Fax +46 (0)271-27501  
[www.edsbyn.com](http://www.edsbyn.com)

Date:

2017-03-01

Nr:

00530211-B

1

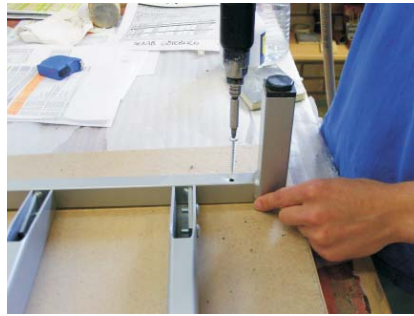

Appliance bag 61167423 should be used. Put out the middle frames, assemble the plinth gable on the middle frame with screw M6x16. Put the complete leg frame on the bottom, first screw on the plinth gables with screw 5,0x45 in the predrilled holes, then use screw 4,5x25 in the small mounting rings on the middle frame.

2



Assemble 9 Minifix bolts 15BL B24/5 mm Fz

3

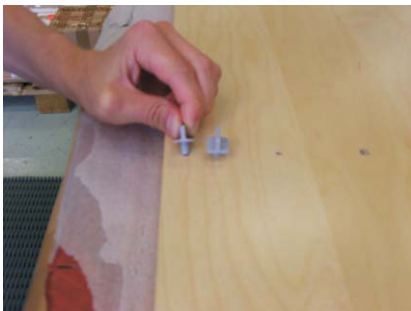

Assemble 2 controls to sliding door.

4



Press the worm minifix diam. 15/19 fzb, into the sides and middle side, 6 in each. The arrow

5



Screw on the sides and the middle side to the bottom.

6

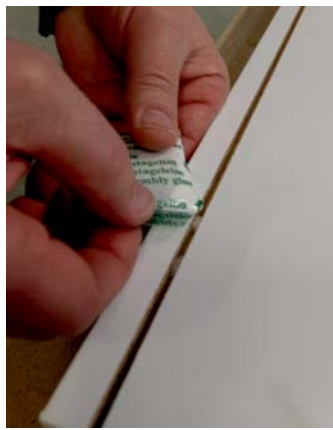

Cut off a small corner of the bag with glue (Note: Keep in mind that the glue is very fluid). Apply glue in the slot on the bottom and in the slot on the backs as illustrated.

7

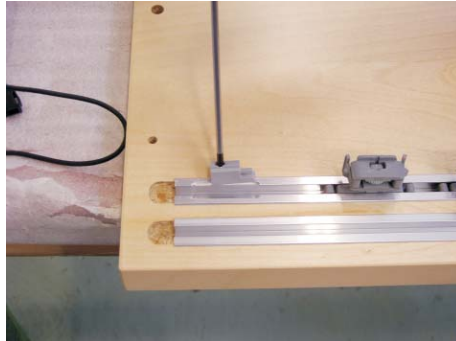
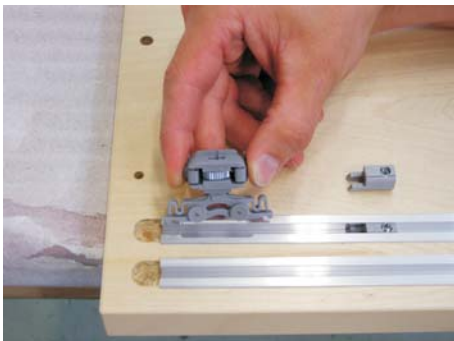

One end stop in each end of the rail. Two trolleys in each rail, should be turned according to picture.

8



Put the board on and lock it with the worm screws.



9



Start with a loose shelf in the ninth hole from the bottom, then a fixed shelf in the 20th hole. (One shelf in each back joint). Lock the shelves. Fixed shelf should be screwed on with system screw FX 6,3x10 Fzb.

10



Assemble the handles with system screw FX 6,2x10 Fzb.

11



Assemble pot adapter with screw 4,0 x 16 fzb pz.

12



First hang the left door on the inner trolleys. Then hang the right one. Adjust the end stops so that the doors close correctly.